

# HANSA 481 / 581 / 681

Stand 9.2011

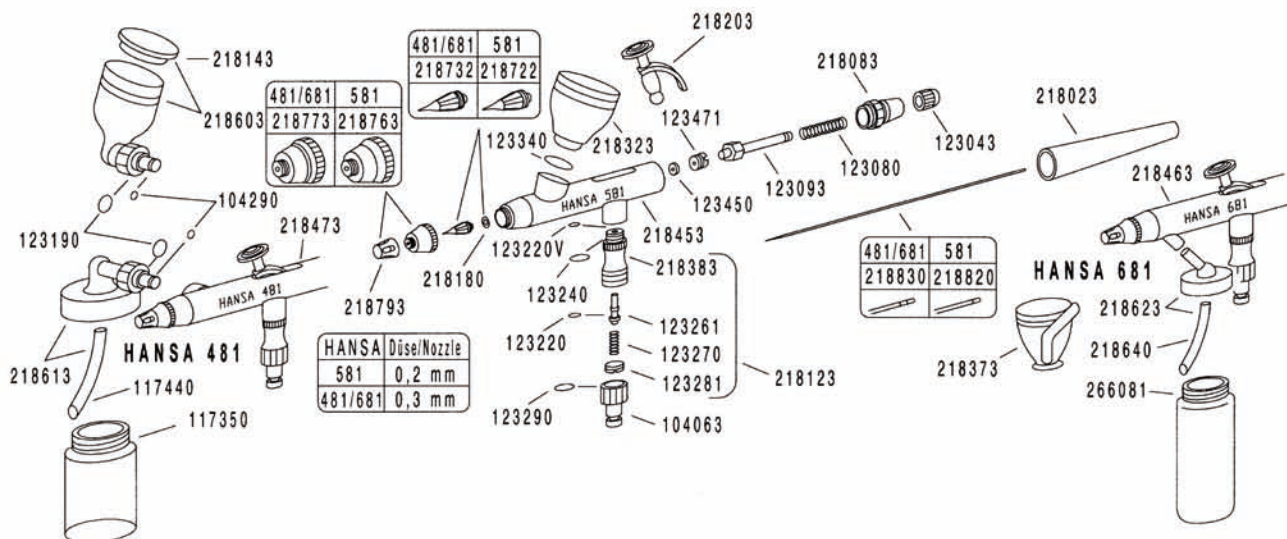

|                |  |               |
|----------------|--|---------------|
| <b>104063</b>  | <b>plug in nipple, nd 2.7mm - G1/8" female thread, with seal</b><br>for all H&S + HANSA models except COLANI     | 4039868040633 |
| <b>104290</b>  | <b>o-ring for side feed system, unit 3 pcs.</b><br>fits to #218603 + #218613<br>for EVOLUTION M + HANSA 481      | 4039868000309 |
| <b>117350</b>  | <b>glass 15ml with plastic lid</b>   | 4039868173508 |
| <b>117440</b>  | <b>hose for glass 15ml</b><br>fits to glass connector<br>#117343 + #218613                                       | 4039868174406 |
| <b>123043</b>  | <b>needle clamping nut</b><br>for all H&S and HANSA models except COLANI   | 4039868230430 |
| <b>123080</b>  | <b>needle spring</b><br>for EVOLUTION, INFINITY, GRAFO + HANSA   | 4039868230805 |
| <b>123093</b>  | <b>needle chuck</b><br>for EVOLUTION, INFINITY + HANSA 481/581/681   | 4039868230935 |
| <b>123190</b>  | <b>o-ring for air cap, unit 3 pcs.</b><br>fits also to side feed system #218603 + #218613, VITON special quality | 4039868231901 |
| <b>123220</b>  | <b>o-ring for valve rod</b><br>unit 3 pcs., for all H&S + HANSA models   | 4039868232205 |
| <b>123220V</b> | <b>seal consisting of PTFE for valve shaft, unit 3 pcs.</b><br>for all H&S + HANSA models except COLANI          | 4039868003201 |
| <b>123240</b>  | <b>o-ring for valve body + fPc valve, unit 3 pcs.</b><br>for all H&S + HANSA models except COLANI                | 4039868232403 |
| <b>123261</b>  | <b>valve rod with o-ring</b><br>for EVOLUTION, INFINITY, ULTRA + HANSA 481/581/681                               | 4039868232618 |
| <b>123270</b>  | <b>valve spring</b><br>for EVOLUTION, INFINITY, ULTRA + HANSA 481/581/681  | 4039868232700 |
| <b>123281</b>  | <b>valve closure screw</b><br>for all H&S + HANSA models except COLANI   | 4039868232816 |
| <b>123290</b>  | <b>seal for plug in nipple G 1/8"</b><br>unit 3 pcs., fits to #104063 - #104065                                  | 4039868232908 |
| <b>123340</b>  | <b>o-ring for cup</b><br>unit 3 pcs., PTFE   | 4039868233400 |
| <b>123450</b>  | <b>seal consisting of PTFE for needle, unit 3 pcs.</b><br>for all H&S and HANSA models except COLANI             | 4039868234506 |
| <b>123471</b>  | <b>screw for needle seal</b><br>for EVOLUTION, INFINITY, ULTRA + GRAFO   | 4039868234711 |

**HARDER & STEENBECK**

**Airbrush**



| art.-no. | article  | EAN           |
|----------|--|---------------|
| 218023   | <b>end piece</b><br>for ULTRA + HANSA 481/581/681  | 4042165180230 |
| 218083   | <b>waist</b><br>for HANSA 481/581/681  | 4039868004963 |
| 218123   | <b>valve complete</b><br>for HANSA 481/581/681   | 4042165181237 |
| 218143   | <b>lid for cup 5ml</b><br>for EVOLUTION M + HANSA 481  | 4042165181435 |
| 218180   | <b>o-ring for nozzle consisting of PTFE</b><br>unit 3 pcs., for all HANSA models   | 4042165181800 |
| 218203   | <b>lever device complete</b><br>for HANSA 481/581/681  | 4042165182036 |
| 218323   | <b>cup 2ml</b><br>for HANSA 581  | 4042165183231 |
| 218373   | <b>cup 5ml</b><br>HANSA 681<br>with angled plugging pipe for right-handed user   | 4042165183736 |
| 218383   | <b>valve body</b><br>for HANSA 481/581/681   | 4042165183835 |
| 218403   | <b>cup 5 ml</b><br>HANSA 681<br>with angled plugging pipe for left-handed user   | 4042165184030 |
| 218453   | <b>body HANSA 581</b><br>gravity feed system   | 4042165184535 |
| 218463   | <b>body HANSA 681</b><br>suction feed system   | 4042165184634 |
| 218473   | <b>body HANSA 481</b><br>side feed system  | 4042165184733 |
| 218603   | <b>cup with lid 5ml</b><br>for EVOLUTION M + HANSA 481   | 4042165186034 |
| 218613   | <b>siphon side connector for glass 15ml</b><br>for EVOLUTION M + HANSA 481   | 4042165186133 |
| 218623   | <b>adaptor with hose for bottle 30ml</b><br>for pro-color paints and pro-color bodypaints<br>for X-models (suction feed) + HANSA 681 | 4042165186232 |
| 218640   | <b>hose for bottle 30ml</b><br>fits to adaptor #218623   | 4042165186409 |
| 218722   | <b>nozzle 0.2mm (floating tip nozzle), with o-ring</b><br>for HANSA 151, 181, 251, 281 + 581   | 4042165187222 |
| 218732   | <b>nozzle 0.3mm (floating tip nozzle) with o-ring</b><br>for HANSA 351, 381, 451, 481 set, 681 + 681 set                             | 4042165187321 |
| 218763   | <b>air cap 0.2mm, nickel-plated</b><br>for HANSA 481, 581 + 681  | 4042165187635 |
| 218773   | <b>air cap 0.3mm, nickel-plated</b><br>for HANSA 481, 581 + 681  | 4042165187734 |
| 218793   | <b>needle cap</b><br>for HANSA 481/581/681   | 4042165187932 |
| 218820   | <b>needle 0.2mm (floating tip nozzle system)</b><br>for HANSA 151, 181, 251, 281 + 581   | 4042165188205 |
| 218830   | <b>needle 0.3mm (floating tip nozzle system)</b><br>for HANSA 351, 381, 451, 481 Set, 681 + 681 Set                                  | 4042165188304 |
| 223663   | <b>Quick Fix end piece, complete, nickel-plated</b><br>innovative colour adjustment with<br>memory function for all HANSA models     | 4042165236630 |
| 266081   | <b>plastic bottle 30ml</b><br>with lid and shake-stone - solvent resistant   | 4042165660817 |
| 218930   | <b>sealing kit complete</b><br>for all HANSA models  | 4042165189301 |
| 123933   | <b>screwdriver</b><br>for mounting of the needle seal for all H&S and<br>HANSA models; except COLANI                                 | 4039868239334 |
| 91012    | <b>case 235 x 185 x 48 mm, black/transparent</b><br>for XL2000, EVOLUTION SILVERLINE M and<br>HANSA 681 set                          | 4039868000323 |
| 92005    | <b>Etui für HANSA 581, schwarz rotes Inlay / SOLO</b><br>wird ersetzt durch HARDER solo  |               |